

SEE NOTE 2

BOTTOM VIEW

RAISED PAVEMENT MARKER COLORS	
TYPE 1W	NONREFLECTORIZED WHITE
TYPE 1Y	NONREFLECTORIZED YELLOW
TYPE 2W	REFLECTORIZED WHITE – ONE SIDE ONLY
TYPE 2Y	REFLECTORIZED YELLOW – ONE SIDE ONLY
TYPE 2YY	REFLECTORIZED YELLOW – BOTH SIDES
TYPE 2YR	REFLECTORIZED YELLOW/RED
TYPE 2WR	REFLECTORIZED WHITE/RED

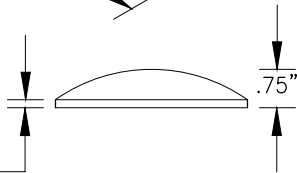
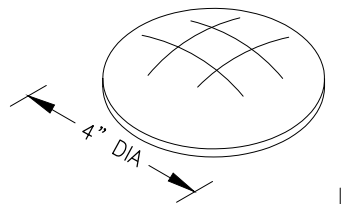

TYPE 1 RPM

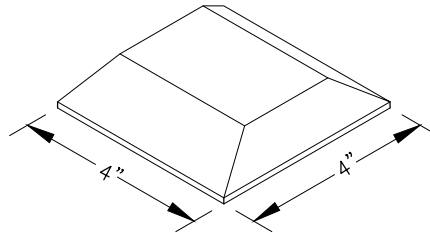

PRISMATIC REFLECTIVE FACE (TYP)

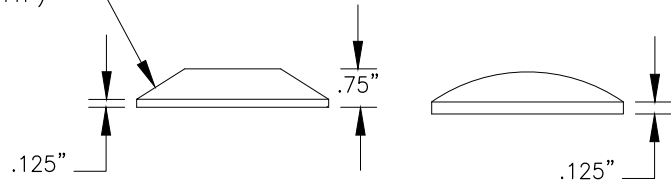

TYPE 2 RPM

NOTES:

1. TYPE 1 MATERIAL- MARKER SHALL BE MOLDED OF A HIGH IMPACT, RECYCLED ACRYLONITRILE BUTADIENE STYRENE (ABS), CONFORMING TO ASTM SPEC DI 78888.
2. MARKER BOTTOM SHALL ALLOW UPWARD FLOW OF ADHESIVE AND VENTING TO PREVENT AIR ENTRAPMENT.
3. ALL CHANNELIZATION (OR PAVEMENT MARKINGS) SHALL BE LAID OUT WITH SPRAY PAINT AND APPROVED BEFORE FINAL INSTALLATION. APPROVALS SHALL REQUIRE ADVANCE NOTICE OF THREE WORKING DAYS TO HAVE FIELD LAYOUT APPROVED.

NOT TO SCALE



**CITY OF DES MOINES
PUBLIC WORKS DEPARTMENT**

ENGINEERING SERVICES
21650 11TH AVENUE SOUTH
DES MOINES, IA 50319



RAISED PAVEMENT MARKER DETAILS

DM.F2.8

REVISED: 02/23